



GEARHEADS Frame size 70mm sq. (2.76 in.sq.)

METAL TYPE & BALL BEARING TYPE

▶ **RATED TORQUE OF GEARHEAD**

MODEL	Speed(rpm)	500	300	200	120	100	60	50	30	20	15	10	9
	Ratio	50Hz	3	5	7.5	12.5	15	25	30	50	75	100	150
60Hz		3.6	6	9	15	18	30	36	60	90	120	180	200
L7HK□M L7HK□B	kg-cm	2.8	4.7	7.1	11.8	14.2	21.4	25.6	38.6	50	50	50	50
	N-m	0.28	0.46	0.7	1.16	1.39	2.09	2.51	3.78	4.9	4.9	4.9	4.9
	oz-in	39	66	99	165	197	297	356	536	694	694	694	694

- * The normal torque is that the motor and gearhead are directly coupled.
- * Insert the denominator of reduction ratio in □ of gearhead model name.
- * Actual rotation speed is 2~15% less than synchronous speed.
- * ■Color indicates that the rotation of gearhead shaft is in opposite direction as output shaft of motor.

INDUCTION MOTORS

DIMENSIONS

Unit : mm(inch)

DECIMAL GEARHEAD

L7G10D

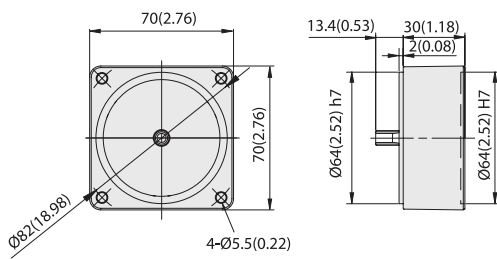

WEIGHT 0.3kg(0.66 lb)



GEARHEAD

L7HK□ M(B)

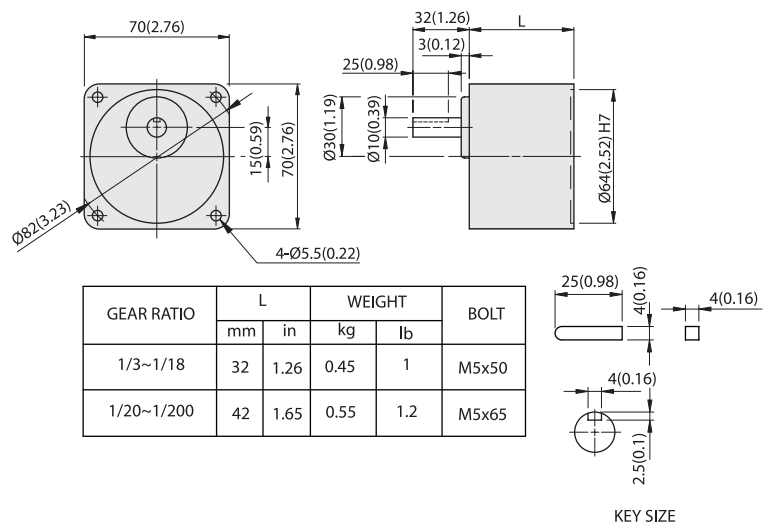

L7HK□ M(B) + L7115P□ L

